

WORK SAFELY

**LEGEND**

Existing Trees (Symbol) New Trees (Symbol)

Stormwater Main (Symbol) Stormwater Disposal (Symbol)

Existing Fencing (Symbol) Fencing by Contractor (Symbol)

Underground Power (Symbol) Overhead Power (Symbol)

100 Dia Stormwater (Symbol)

Trees to be removed (Symbol) (To be removed prior to commencement of building operations.)

A.G. Drain (Symbol) Sewer Pipe (Symbol)

Fencing by Contractor (Symbol) Grated Drain (Symbol)

**NOTE:** MIN. 200mm REINFORCED CONCRETE SLAB REQUIRED. SEE CUT & FILL LEVELS MAY VARY DUE TO SITE CONDITIONS.

**DETAILS**

**DATE:** RL 38.405 (AHD)

**CONTOUR INTERVALS:** 0.20 Metres

**WATER CONNECTION:** (BY THE BUILDER) 20mm line from water meter to entry point.

**WASTE DISPOSAL:** (BY THE BUILDER) Connection to mains sewer in accordance with local authority requirements.

**ROOFWATER DISPOSAL:** (BY THE BUILDER) Connection of all downpipes to underground drain. Position of roofwater lines are indicative only and may vary depending on site.

**POWER CONNECTION:** Installation of underground line by the builder. Connection of power to main line by Electricity Authority.

**EARTHWORKS:** (BY THE BUILDER) AG Drains: 0 Metres Cut and fill to create level building platform. Remove spoil from site. Earthworks indicated on the plan are for construction purposes only.

**LOCAL AUTHORITY:**

**TITLE PARTICULARS:**

LOT: DIM PLAN: PARISH: COUNTY: VOL: FOL:

**LOCATION:** LAT: -33.92122 LONG: 151.05367

MAP REFERENCE: LONG: 151.05367

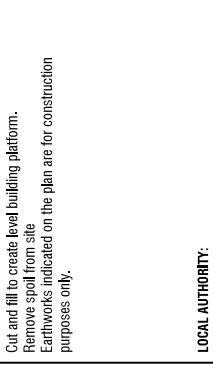

**AMENDMENTS**

1	DB 14.03.22	Approved by council
2	DB 17.03.22	Please refer to the requirements

<b>01-3</b>	
SHEET NO. 3 of 15	
HAND: Corella	
CONTRACT NO:	196970
SPECIFICATION:	N.S.W. NHC WO
S.I. No.	MSR Nk 13.12.21 DB 25.01.22
ISSUE	05 22/5/18
GEN:	
DATE:	

**NEW HOME CONTRACT 1**

RESIDENCE FOR: **Kim Sung Hee**  
**Lot A, 33 Sharp Street,**  
**Belmore NSW 2192**

**Burbank**  
#frappaccalifehome

Burbank Australia (NSW Pty Ltd ph: (02) 9528 0353 fx: (02) 9528 0222  
ABN: 68 618 822 770, ACR: 610 822 770, BL: 2356827C

please consider the environment before printing this sheet. P.U. File Swwd 30/03/2022, 15:45PM (Dwain Berg)

**LOT A / 121**  
**EXISTING DWELLING**  
**KNOCK DOWN REBUILD**  
**AREA: 505.9m<sup>2</sup>**  
**DP 365425**

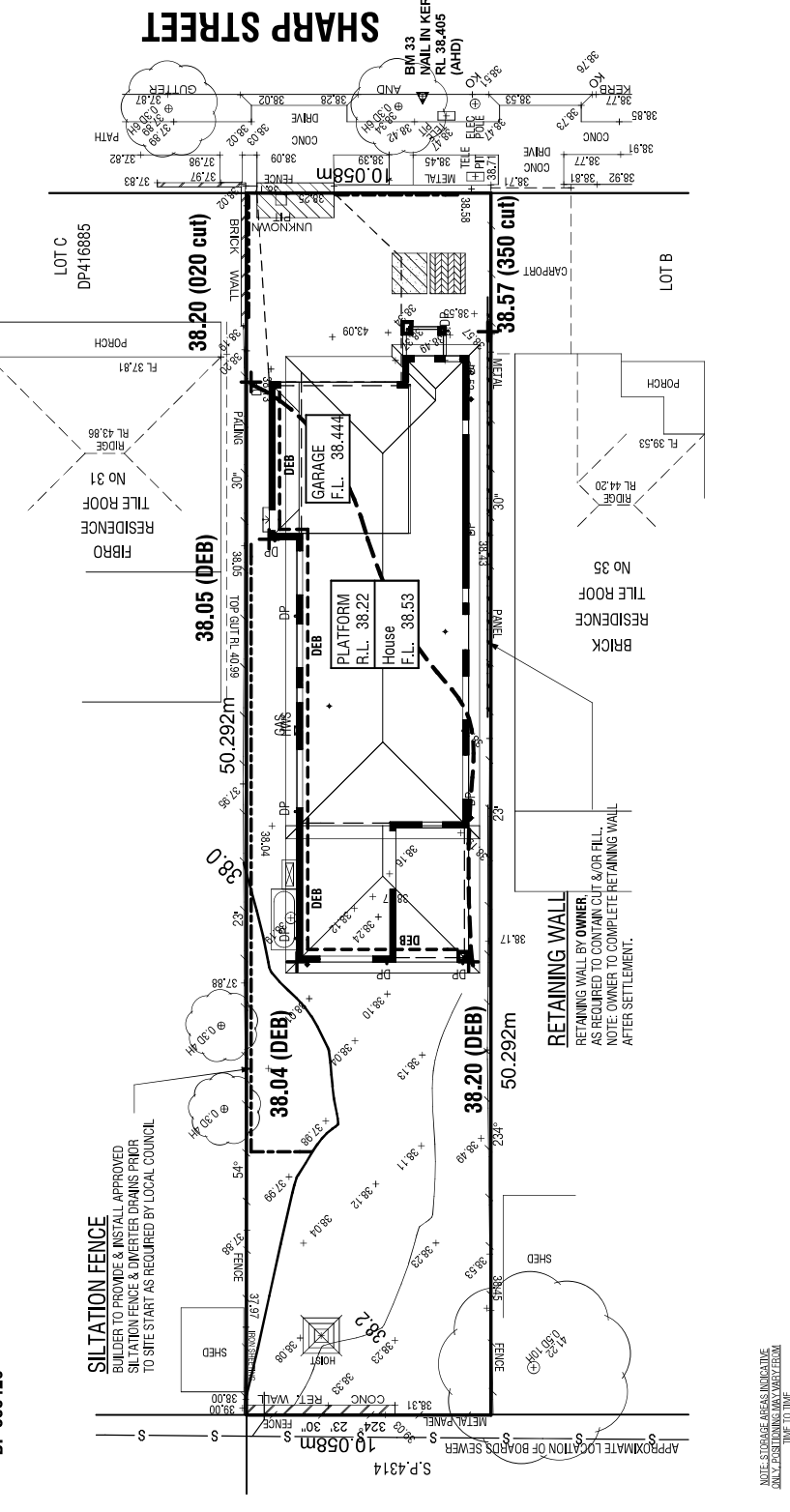

**SEDIMENT CONTROL NOTES**

1. ALL EROSION AND SEDIMENTATION CONTROL MEASURES, INCLUDING SILTATION FENCES, SHALL BE INSTALLED PRIOR TO THE COMMENCEMENT OF ANY WORK AND MAINTAINED TO THE STANDARD OF THE ACT. CONSTRUCTION OF NEW WORK SHALL BE STOPPED IMMEDIATELY IF THE SILTATION FENCE IS DAMAGED OR BREACHED. AS FAR AS POSSIBLE, DURING DEVELOPMENT, AROUND ALL INLET PIPES, CONDUITS, AND DRAINAGE SYSTEMS, THE SILTATION FENCE SHALL BE MAINTAINED AT A MINIMUM OF 60% FULL OF SOIL MATERIALS.
2. ALL DAMAGED SILTATION FENCES SHALL BE REINSTALLED AS SOON AS THE DAMAGE IS IDENTIFIED AND REPAIRS COMPLETED.
3. SOIL AND ROCK SHALL BE STORED UNDER COVER AND PROTECTED FROM WIND AND RAIN.
4. ALL STORED SOIL AND ROCK SHALL BE COVERED WITH A MINIMUM OF 100mm OF SOIL MATERIALS.
5. ALL STORED SOIL AND ROCK SHALL BE COVERED WITH A MINIMUM OF 100mm OF SOIL MATERIALS.
6. ALL STORED SOIL AND ROCK SHALL BE COVERED WITH A MINIMUM OF 100mm OF SOIL MATERIALS.
7. ALL STORED SOIL AND ROCK SHALL BE COVERED WITH A MINIMUM OF 100mm OF SOIL MATERIALS.
8. ALL STORED SOIL AND ROCK SHALL BE COVERED WITH A MINIMUM OF 100mm OF SOIL MATERIALS.
9. ALL STORED SOIL AND ROCK SHALL BE COVERED WITH A MINIMUM OF 100mm OF SOIL MATERIALS.
10. ALL STORED SOIL AND ROCK SHALL BE COVERED WITH A MINIMUM OF 100mm OF SOIL MATERIALS.

**LEGEND**

MATERIAL STORAGE AREA (Symbol)

ALL WEATHER ACCESS (Symbol)

RECYCLING WASTE AREA (Symbol)

SILTATION FENCE (Symbol)

CUT & FILL LINE (Symbol)

FALL (Symbol)

SITE CUT (Symbol)

SITE FILL (Symbol)

TOP OF FILL BATTERY (Symbol)